

TENANT INDEX

2	KOHL'S	96,212
4	FAMOUS FOOTWEAR	6,212
6	VAN'S NAILS	1,884
8	AVAILABLE	2,700
10	CHRISTOPHER & BANKS	6,600
12	BARNES & NOBLE	25,000
14A	DRESS BARN	8,000
14B	THE TILE SHOP	15,578
14C	FIVE BELOW	10,328
16	OLD NAVY	12,325
18	PETCO	15,000
20	MICHAELS	23,078
21	BED BATH & BEYOND	29,706
22	PIER 1 IMPORTS	9,242
U1	CUB FOODS	88,364

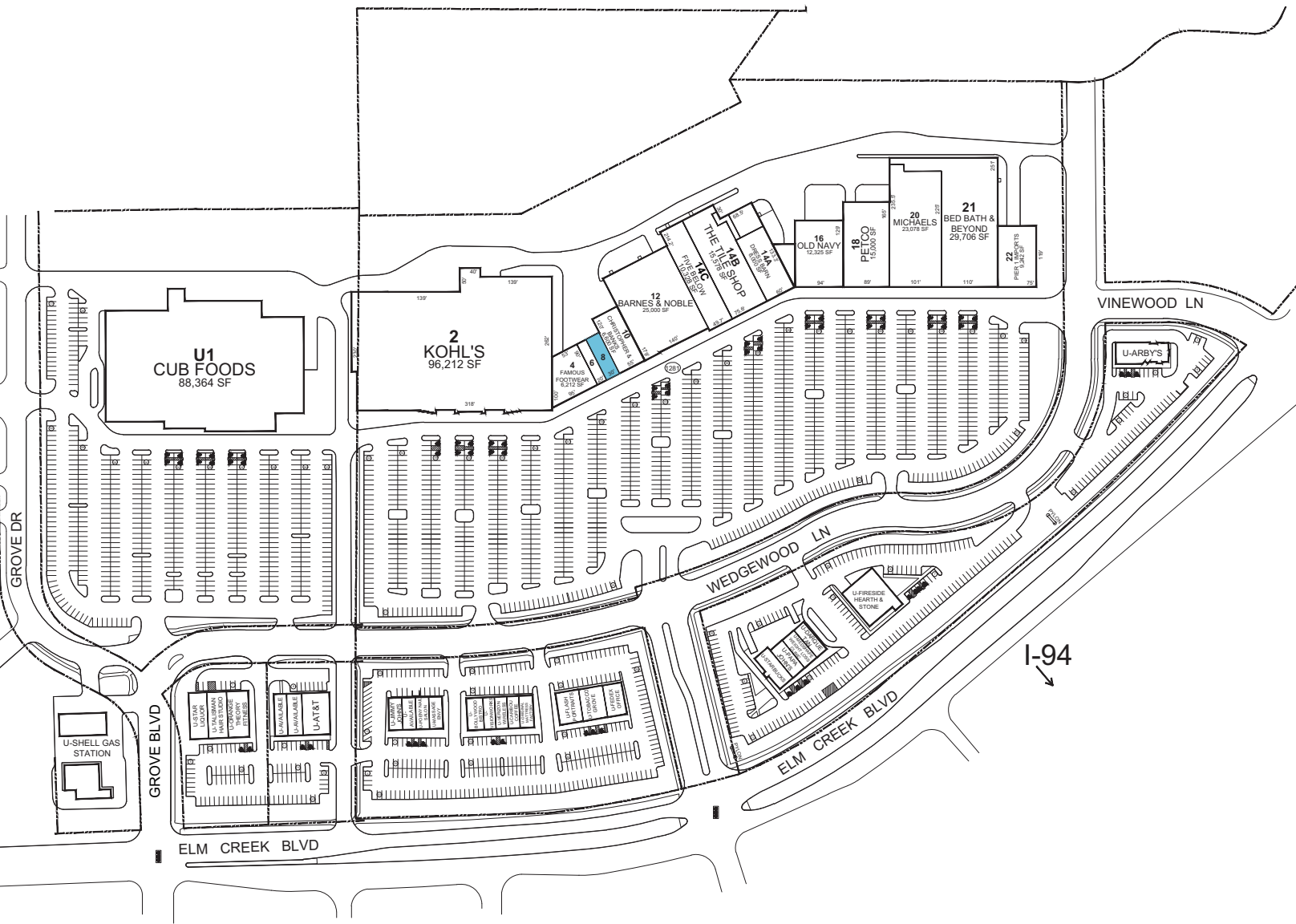

MAPLE GROVE CROSSING
 Weaver Lake Rd & Elm Creek Blvd N
 MAPLE GROVE, MN 55369

Latitude: 45.1003, Longitude: -93.4486

AVAILABLE



THIS DRAWING IS FOR GENERAL INFORMATION PURPOSES ONLY AND IS INTENDED FOR USE AS A REFERENCE ONLY. THIS DRAWING IS NOT INTENDED TO REPRESENT THE ACTUAL SIZE, DIMENSIONS, OWNERSHIP, OR TENANCY OF THE MATTERS DEPICTED. ANY AND ALL FEATURES AND INFORMATION ARE FOR ILLUSTRATIVE PURPOSES ONLY, AND ARE SUBJECT TO CHANGE WITHOUT NOTICE.

3300 Enterprise Parkway, Beachwood, OH 44122
 Fax 216 . 755 . 1500 Phone 216 . 755 . 5500